

Suspended Tote Holder, 4-Legged Table Mount

Product Numbers

- STHF5

Hardware Pack: STHSHP (p/n 14090801-01)

Required Tools

- 1/8" Drill Bit
- #2 Phillips Bit and/or Screwdriver
- Cordless Drill/Driver

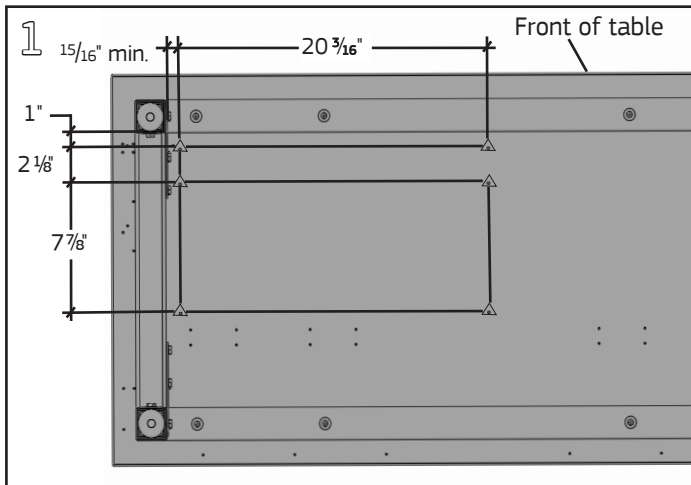

Determine placement of Tote Holder along width of table. Mark and drill (6) 1/2" deep pilot holes in the surface per dimensions using a 1/8" Drill Bit and cordless drill/driver.

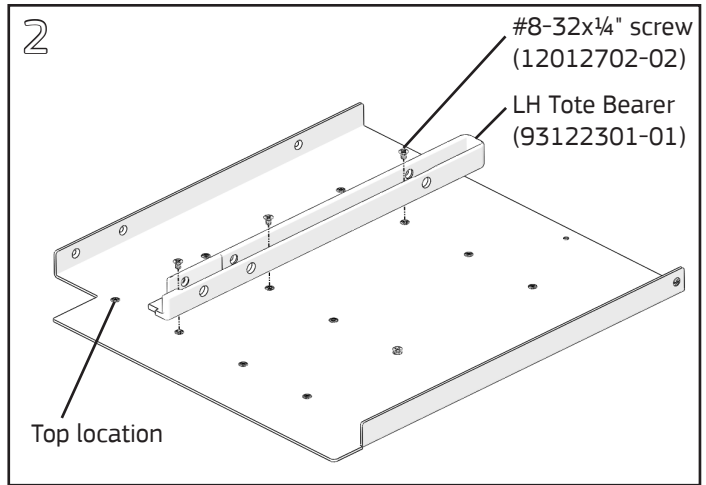

Lay the left-hand Tote Holder panel flat and assemble a left-hand tote bearer in all locations except the top with (3) #8-32x1/4" Phillips flat head screws per bearer using a #2 Phillips screwdriver.

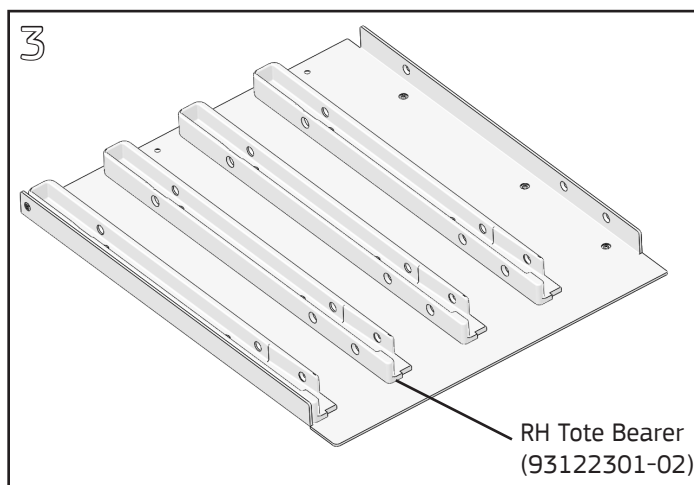

Repeat with right-hand Tote Holder panel.

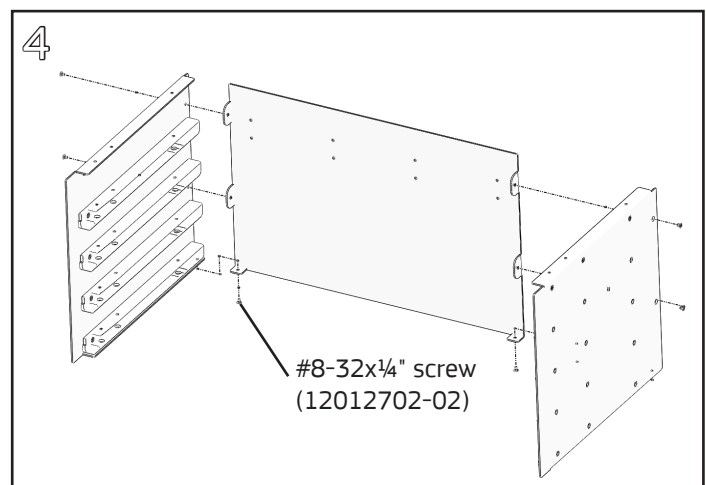

Assemble left and right Tote Holder panels to Tote Holder back using (6) #8-32x1/4" Phillips flat head screws.

Suspended Tote Holder, 4-Legged Table Mount

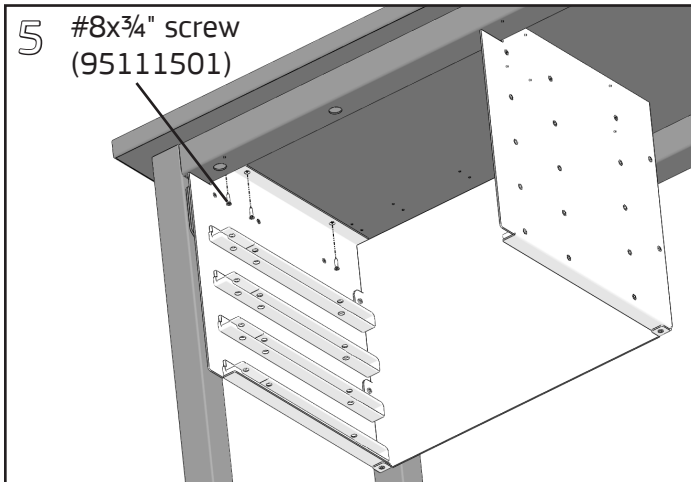

Align holes in top flanges of Tote Holder with the pilot holes in the surface. Attach with (6) #8x3/4" Phillips flat head screws using a **#2 Phillips driver**.

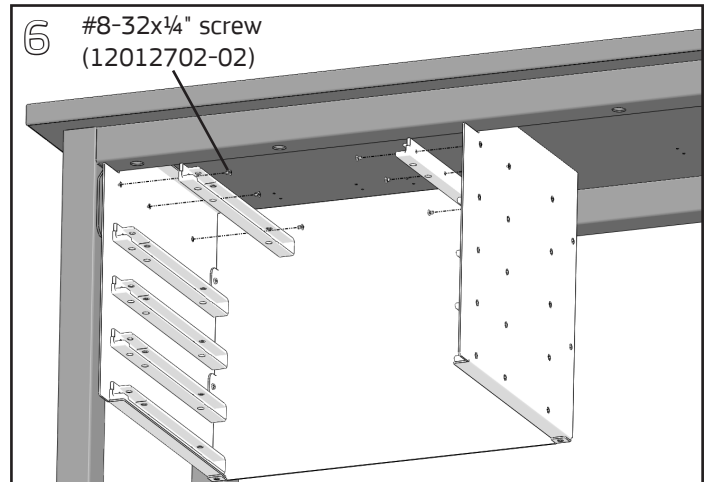

Attach the left and right tote bearers in the top locations of the side panels with (3) #8-32x1/4" Phillips flat head screws per bearer using a **#2 Phillips screwdriver**.