

## Storage Shelves

### Product Numbers

- SH15xx
- SL15xx

### Required Tools

- #2 Phillips Screwdriver
- Tape Measure

Hardware Pack: none

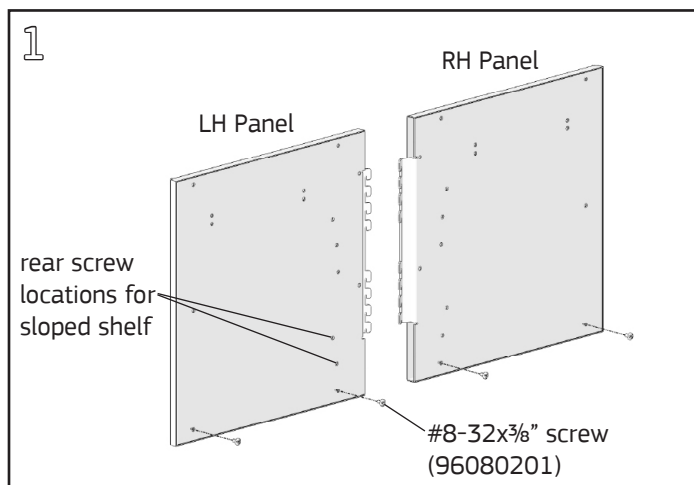

Install two #8-32x $\frac{3}{8}$ " Phillips pan head screws into the lower holes on each end panel leaving an  $\frac{1}{8}$ " gap between the panel and screw. To install the shelf in a sloped position, install the rear screw in one of the higher positions of the end panel.

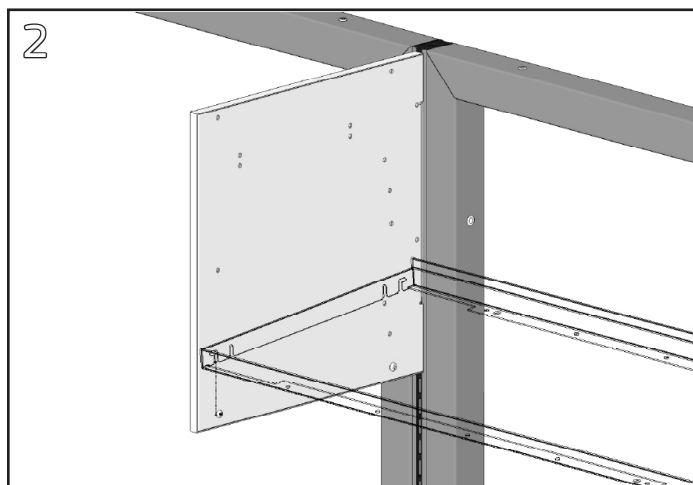

With the screws to the inside, install the end panels on the left and right sides of the frame. Ensure the panels are firmly seated in the hanger frame slots and use a tape measure to verify both panels are at the same height.

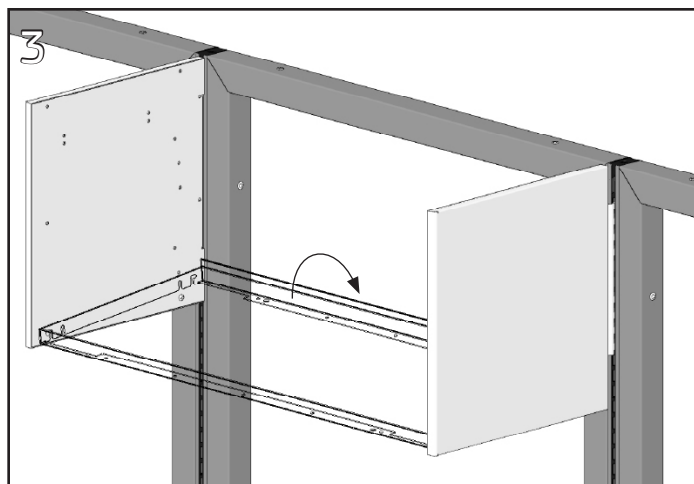

For a flat shelf, orient the lip toward the back and engage the dog-leg slots in the sides of the shelf with the front screws in the end panel. If installing in a sloped position, the shelf lip should be at the front.

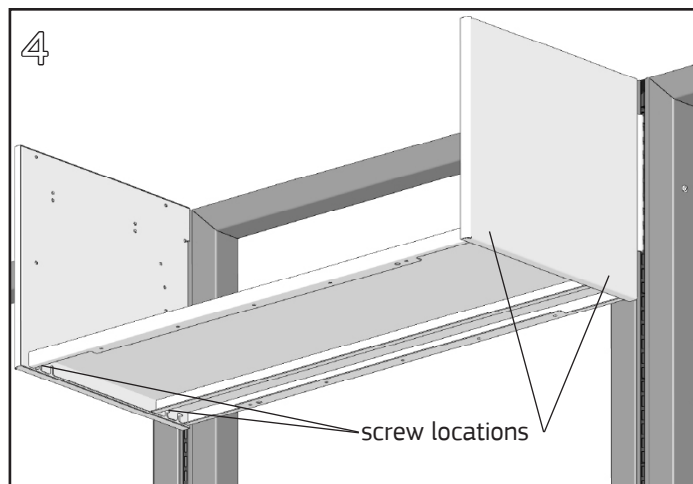

Rotate the shelf down toward the back until the straight slots in the sides of the shelf slide over the rear panel screws. Tighten all four screws with a #2 Phillips screwdriver.