

Auxiliary Work Surface

Product Numbers

- AWS1518

Hardware Pack: AWSHP (p/n 14071506-01)

Required Tools

- #2 Phillips Screwdriver and/or #2 Phillips Bit
- Cordless Drill/Driver

WARNING: Do not tighten the #10-12 surface screws more than 25 in-lbs. in laminated surfaces or 40 in-lbs. in phenolic surfaces. Drill $\frac{1}{8}$ " diameter pilot holes for laminated surfaces or $\frac{11}{64}$ " diameter pilot holes for phenolic surfaces.

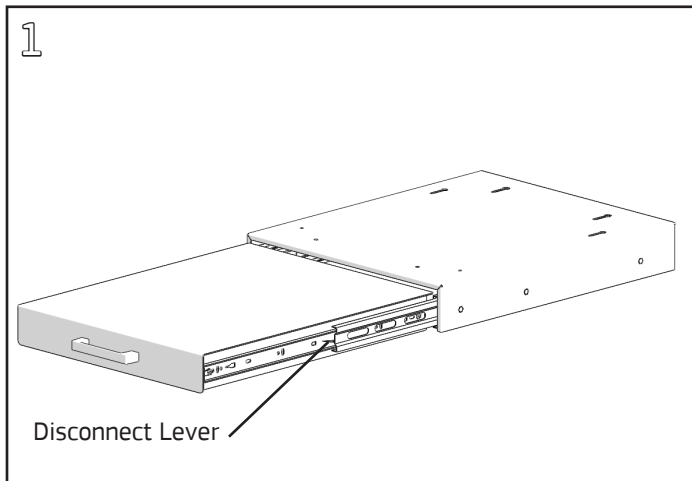

Remove the work surface from the housing by fully extending the slides and pressing the disconnect lever on the side of each slide.

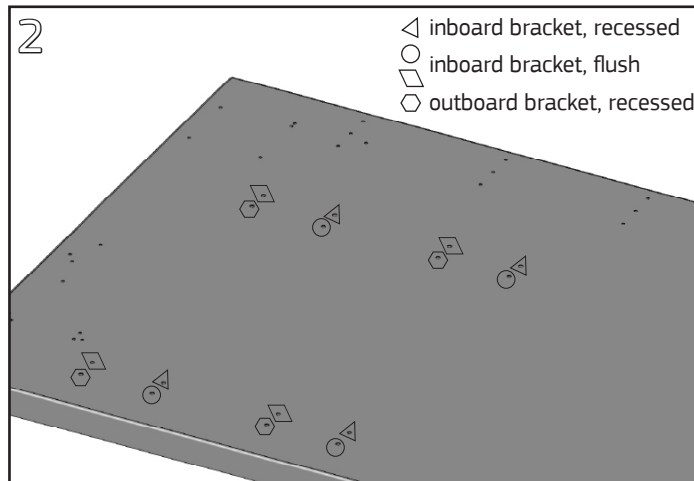

Determine the left-right mounting position for the Auxiliary Work Surface based on the location of the top supporting bracket. The surface can also be positioned flush or recessed relative to the front edge of the top.

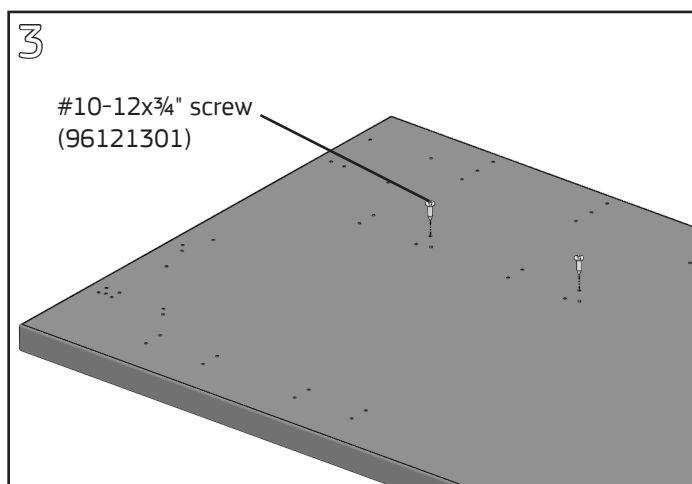

Install (2) #10-12x $\frac{3}{4}$ " Phillips pan head screws in the rear hole locations. Do not tighten fully; leave a $\frac{1}{8}$ " gap between the underside of the screw and top.

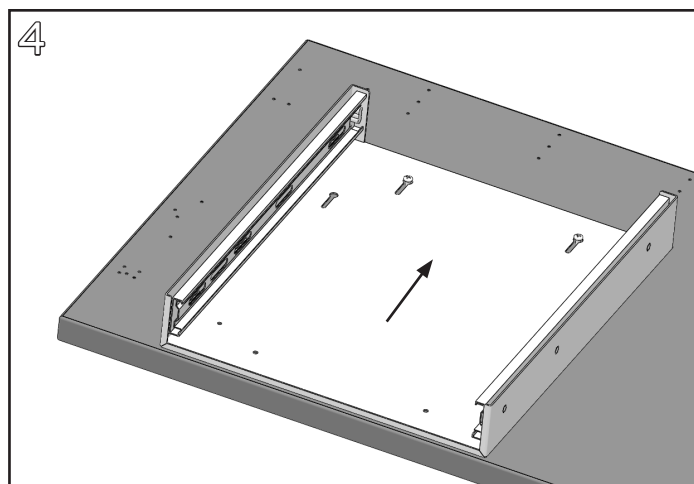

Align the inboard pattern of keyslots in the Auxiliary Work Surface housing with the attachment screws and slide the housing back.

Auxiliary Work Surface

WARNING: Do not tighten the #10-12 surface screws more than 25 in-lbs. in laminated surfaces or 40 in-lbs. in phenolic surfaces. Drill $\frac{1}{8}$ " diameter pilot holes for laminated surfaces or $\frac{11}{64}$ " diameter pilot holes for phenolic surfaces.

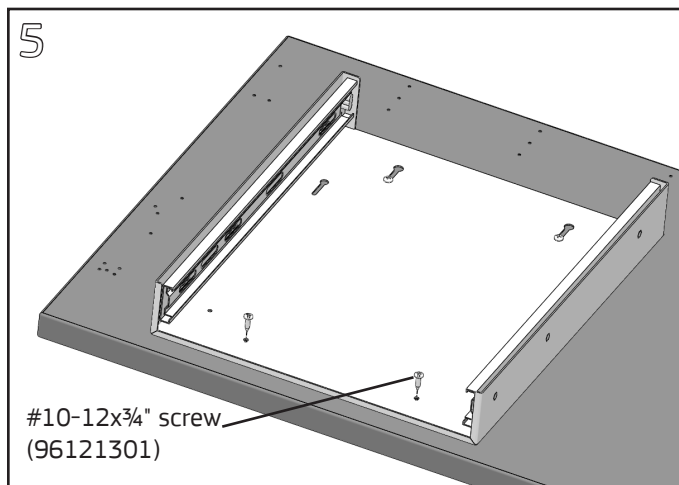

Install (2) additional #10-12x $\frac{3}{4}$ " Phillips pan head screws near the front of the housing. Tighten all (4) screws securely.

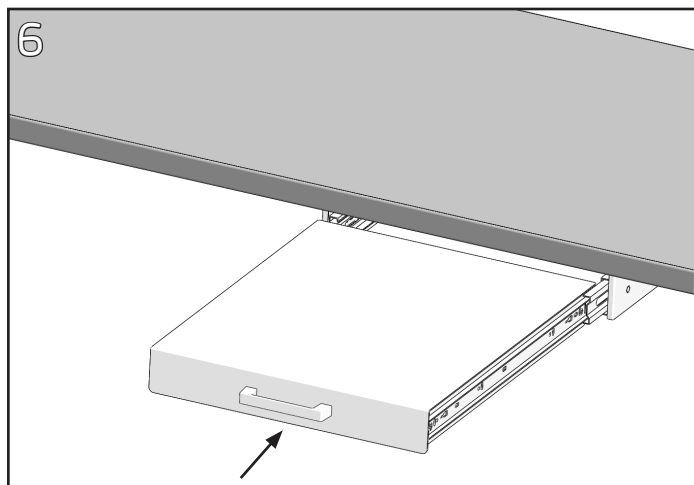

Align the slide members attached to the Auxiliary Work Surface with the slide members in the housing and push the surface into the housing until slides are fully engaged.

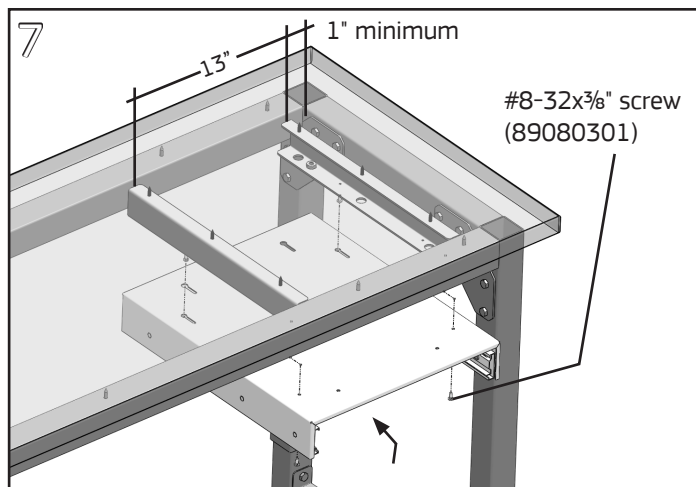

If mounting Auxiliary Work Surface to Storage Accessory Mounting Brackets on a 4-Legged Table, attach Storage Accessory Mounting Brackets with a 13" spacing and fasten Auxiliary Work Surface housing to the brackets with (4) #8-32x $\frac{3}{8}$ " Phillips pan head screws in the outboard pattern of keyslots in the Auxiliary Work Surface housing.