

## Magnetic White Board, Panel Mount

### Product Numbers

- MBS24xx

Hardware Pack: MBSHP\*\* (p/n 15011501-03-\*\*)

### Required Tools

- #2 Phillips Screwdriver
- Tape Measure

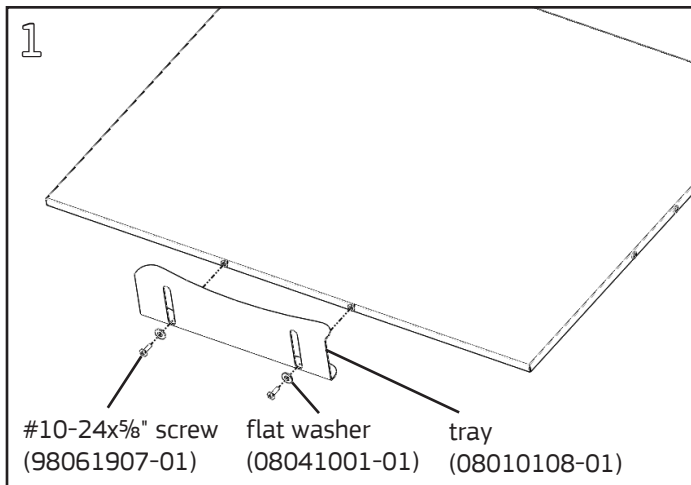

Attach tray to bottom threaded inserts with (2) flat washers and (2) #10-24x5/8" Phillips pan head screw using a **#2 Phillips screwdriver**. Adjust position so that the back lip of the tray touches the back of the white board.

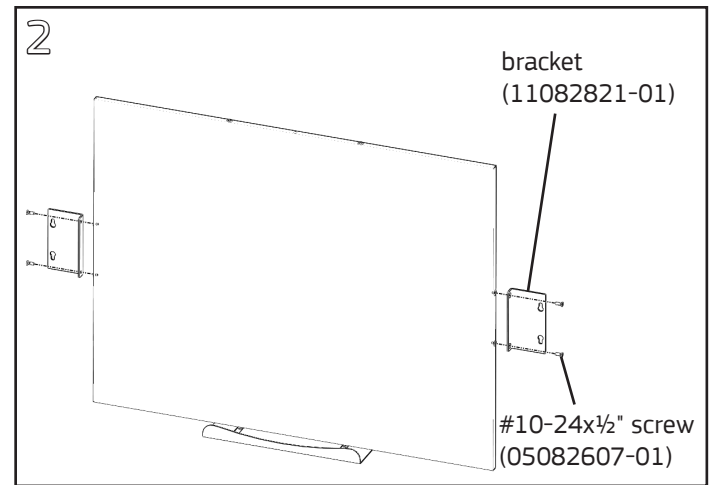

Attach brackets to side threaded inserts with (2) #10-24x1/2" flathead screws per bracket using a **#2 Phillips screwdriver**.

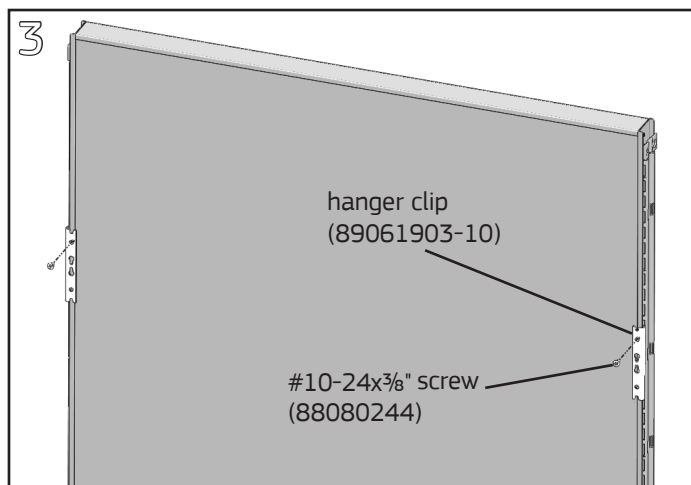

Insert a hanger clip on each side of the panel at the same heights. Install one #10-24x3/8" Phillips pan head screw into the top hole of each hanger clip using a **#2 Phillips screwdriver**, leaving a 1/8" gap between head of screw and clip face.

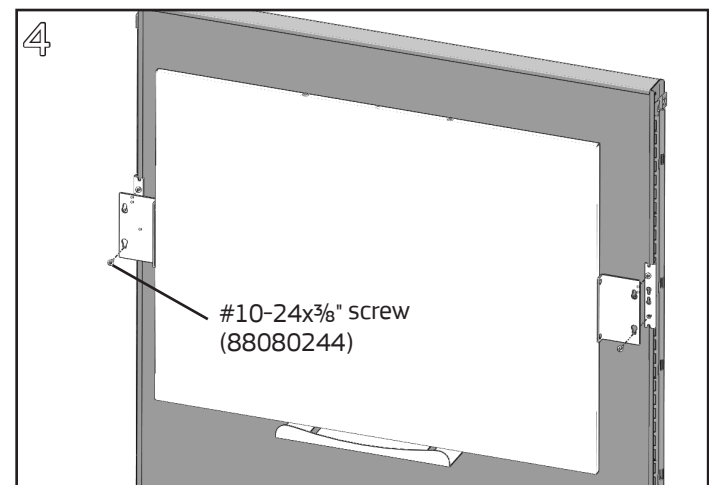

Align screw heads in hanger clips with round center hole in each bracket and slide board down so top of keyslots rest on top screws. Install one #10-24x3/8" Phillips pan head screw into bottom hole on each hanger clip. Tighten all screws.