

## Magnetic White Board, Frame Mount

### Product Numbers

- MBD24xx

Hardware Pack: MBDHP\*\* (p/n 15011501-01-\*\*)

### Required Tools

- #2 Phillips Screwdriver
- Tape Measure

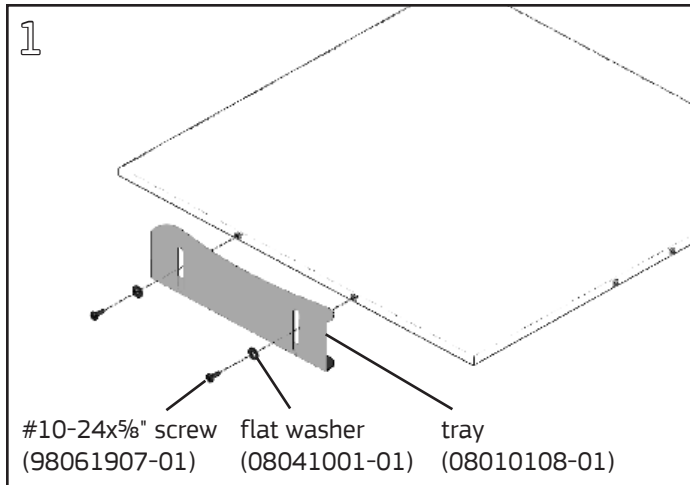

Attach tray to bottom threaded inserts with (2) flat washers and (2) #10-24x $\frac{5}{8}$ " Phillips pan head screw using a **#2 Phillips screwdriver**. Adjust position forward or backward to desired location before fully tightening screws.

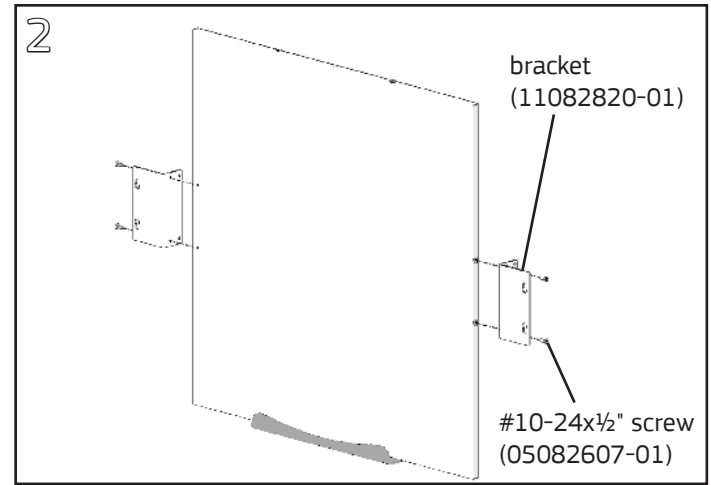

Attach brackets to side threaded inserts with (2) #10-24x $\frac{1}{2}$ " flathead screws per bracket using a **#2 Phillips screwdriver**. White board can be mounted flush with the front of the frame or centered in the frame. Flush mounting is shown.

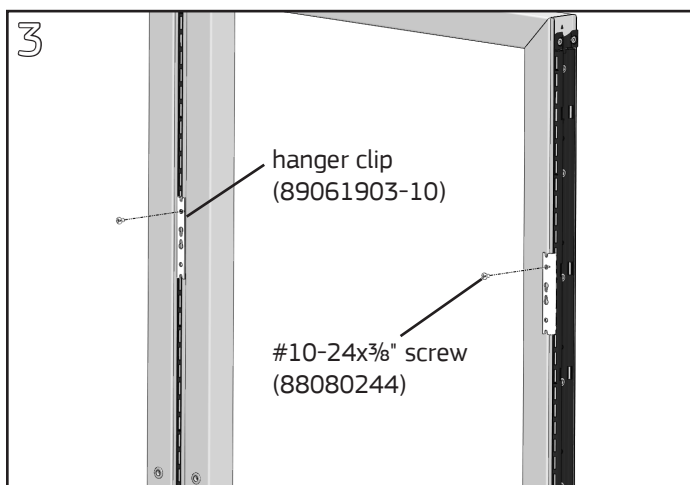

Insert a hanger clip on each side of the UltraFrame at the same heights. Install one #10-24x $\frac{3}{8}$ " Phillips pan head screw into the top hole of each hanger clip using a **#2 Phillips screwdriver**, leaving a  $\frac{1}{8}$ " gap between head of screw and clip face.

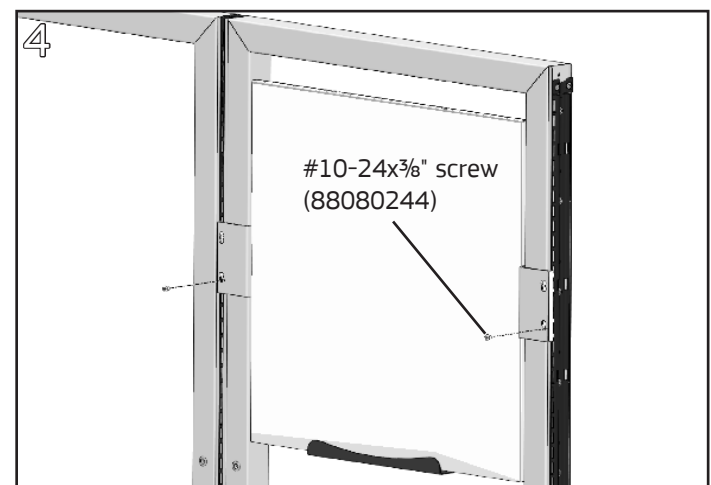

Align screw heads in hanger clip with round center hole in each bracket and slide board down so top of keyslots rest on top screws. Install one #10-24x $\frac{3}{8}$ " Phillips pan head screw into bottom hole on each hanger clip. Tighten all screws.